

Shibaura Institute of Technology (SIT)



SHIBAURA INSTITUTE OF TECHNOLOGY
Established 1927



ABOUT SIT



SHIBAURA INSTITUTE OF TECHNOLOGY

Established 1927

About SIT

- Founded in 1927 as a private university
- Respecting the spirit of Monozukuri (i.e. Craftsmanship)
- Developing skills for career success in globalized job market
- Promoting diversity in the student body



Campus Locations



SHIBAURA INSTITUTE OF TECHNOLOGY

Established 1927



IGP students study on the
TOYOSU Campus.

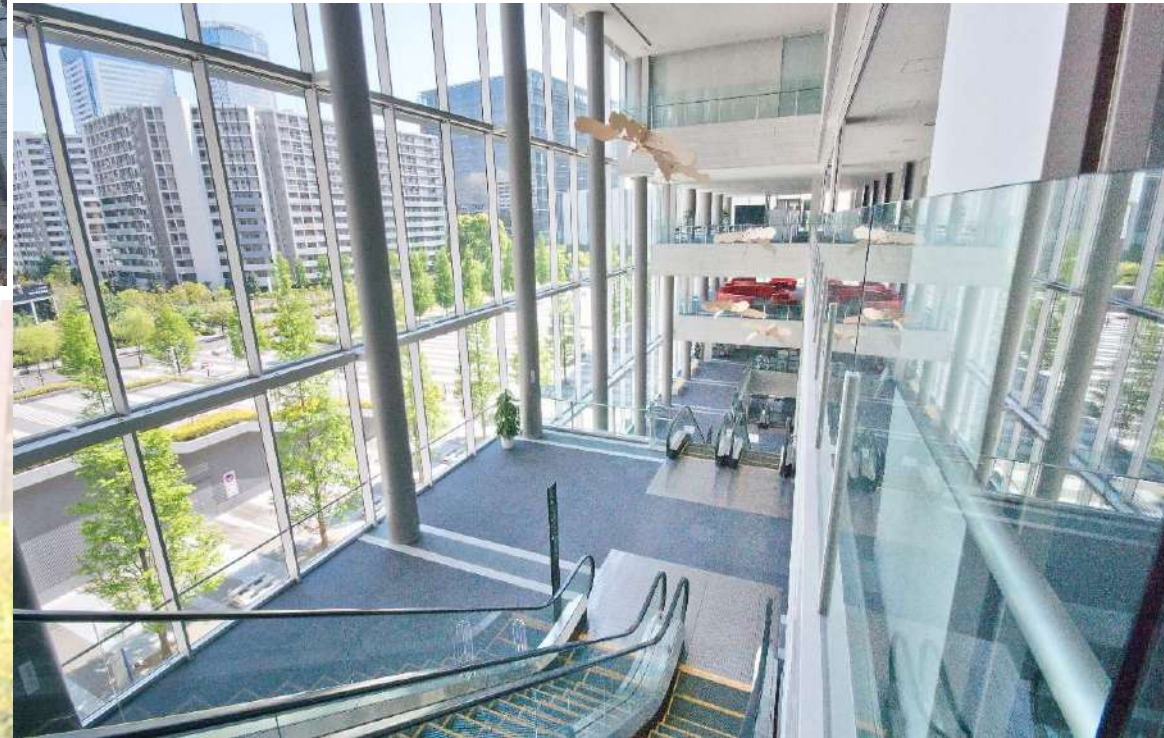

TOYOSU Campus



SHIBAURA INSTITUTE OF TECHNOLOGY
Established 1927

SIT at a glance

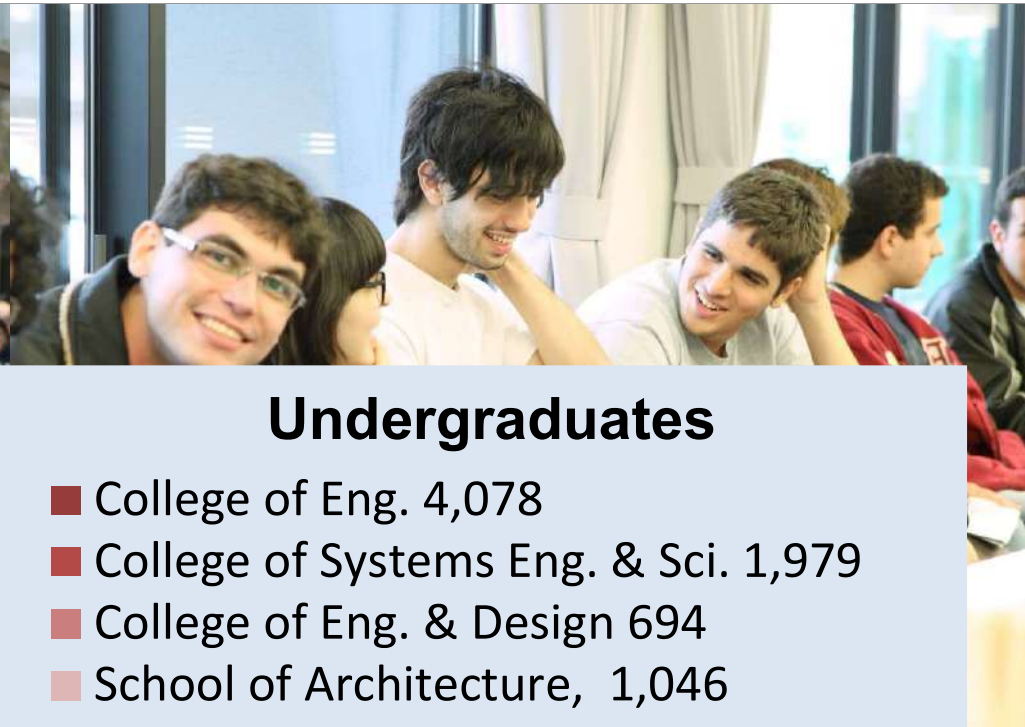

Undergraduates

- Graduates 1,818
- Undergraduates 7,797

- College of Eng. 4,078
- College of Systems Eng. & Sci. 1,979
- College of Eng. & Design 694
- School of Architecture, 1,046

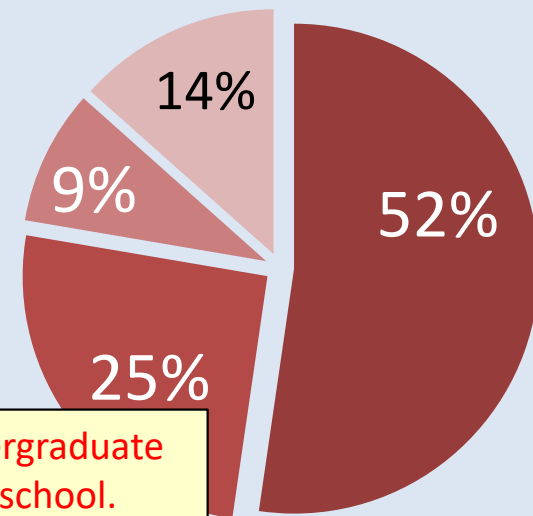
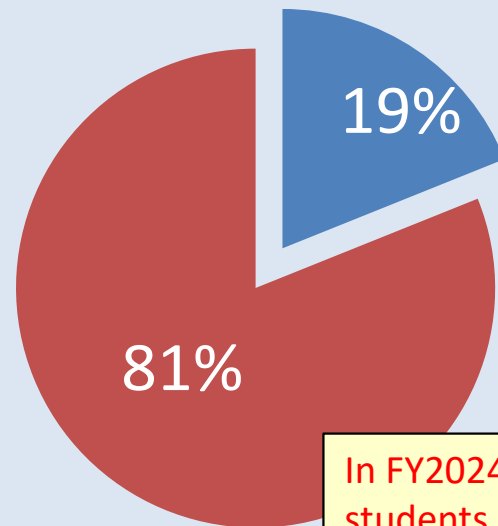

In FY2024, 48% of the undergraduate students entered graduate school.

9,615
Total
Enrollment

As of May 2024



SHIBAURA INSTITUTE OF TECHNOLOGY

Established 1927

SIT at a glance

International Enrollment top 10

	Short term	Middle term	Long term	
Indonesia	275	54	15	344
China	10	40	256	306
Thailand	167	3	18	188
Malaysia	120	6	10	136
Philippine	73	0	2	75
Taiwan	40	8	8	56
Vietnam	40	0	6	46
Korea	11	6	21	38
India	14	8	1	23
Brazil	1	12	7	20

As of May 2022



SHIBAURA INSTITUTE OF TECHNOLOGY

Established 1927

SIT Areas of Study



SCIENCE

**4 Colleges, 16 Departments
and 1 Program**

ENGINEERING



SHIBAURA INSTITUTE OF TECHNOLOGY
Established 1927

SIT has 16 undergraduate departments

Covers most of the majors in the field of Science and Technology.

Engineering

9
Courses

Fundamental Mechanical Engineering

Advanced Mechanical Engineering

Environment and Materials Engineering

Chemistry and Biotechnology

Electrical Engineering and Robotics

Advanced Electrical Engineering

Information and Communications
Engineering

Computer Science and Engineering

Urban infrastructure and Environment

1
Program

IGP (Innovative Global Program)

Systems Engineering and Science

5
Depts.

Electronic Information Systems

Machinery and Control Systems

Architecture and Environment
Systems

Bioscience and Engineering
(2 Courses)

Mathematical Sciences

Engineering and Design

1 Dept

Engineering & Design (3 Courses)

Architecture

1 Dept

Architecture(3 Courses)



SHIBAURA INSTITUTE OF TECHNOLOGY

Established 1927

Areas of Study in the IGP



Materials
Science

Applied
Chemistry

Biomedical
Engineering

Mechanical
Engineering

Computer
Science



SIT at a glance

International Enrollment as a whole

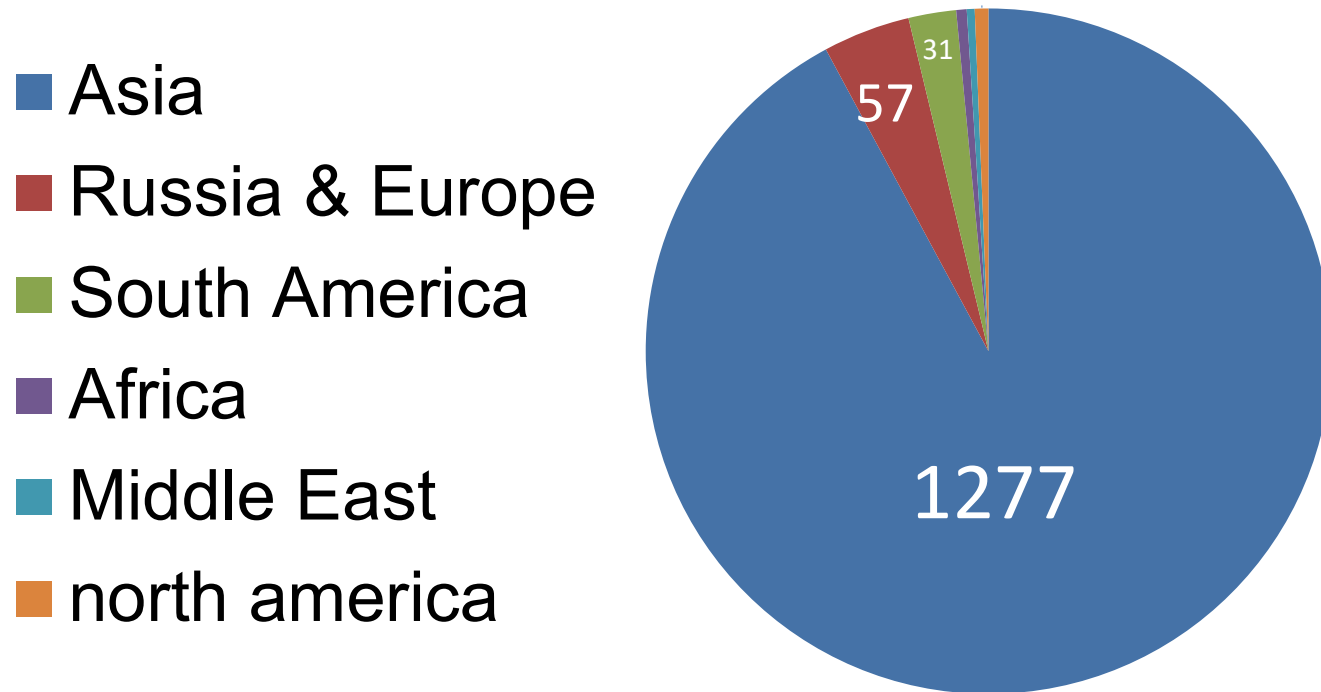

As of May 2022

1,386



SHIBAURA INSTITUTE OF TECHNOLOGY

Established 1927

IGP at a glance

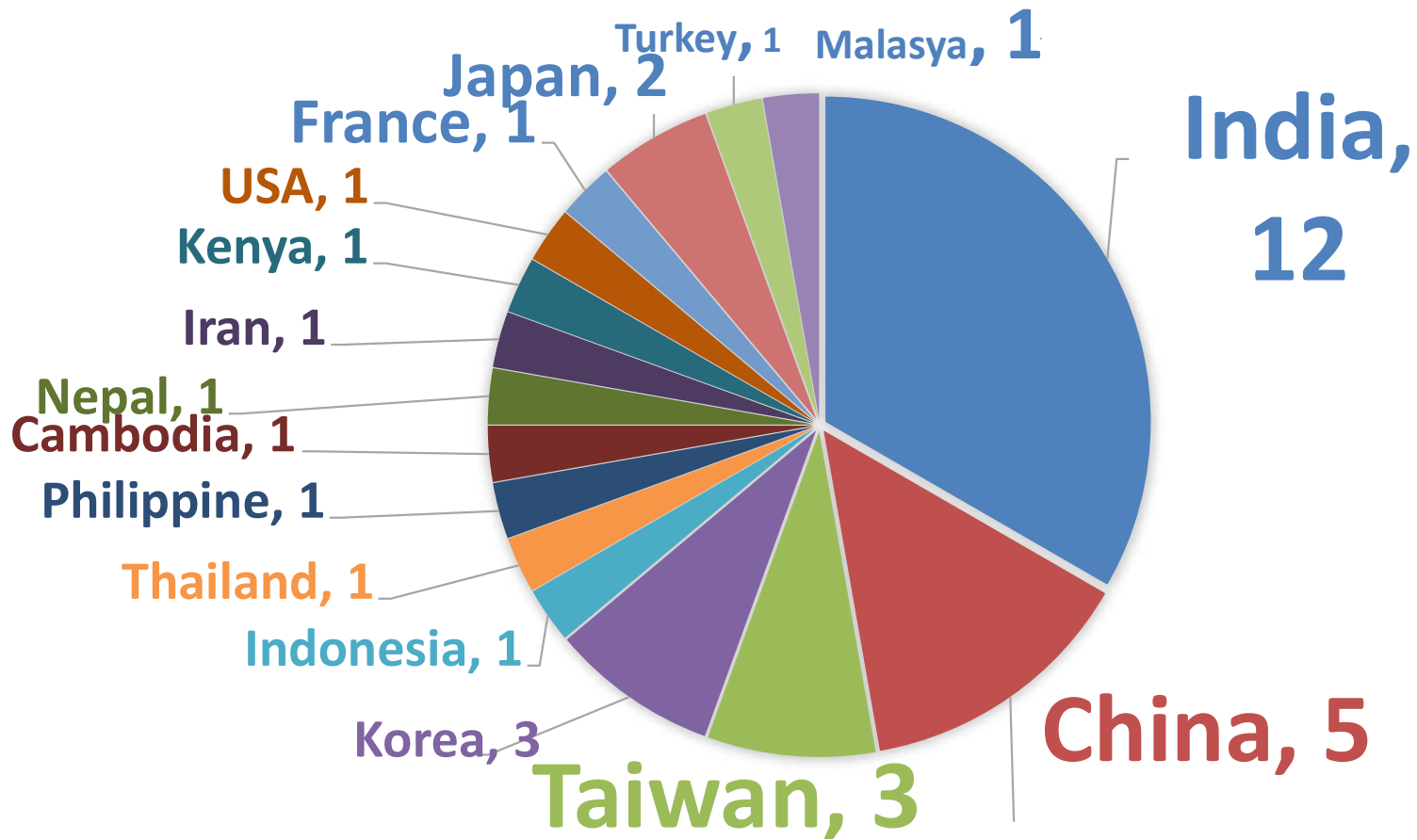

As of May 2024

36



SHIBAURA INSTITUTE OF TECHNOLOGY

Established 1927

Number of applicants and successful applicants

	Admission capacity	Number of Applicants	Number of Enrollment
2021	9	44	8
2022	9	38	8
2023	9	53	13
2024	9	78	TBD



Number of applicants and successful applicants

	Admission capacity	Number of Applicants	Number of Enrollment
2021 Spring Enrollment	9	44	8
2021 Fall Enrollment 1st Admission opportunity			
2021 Fall Enrollment 2nd Admission opportunity			
2022 Spring Enrollment	9	38	8
2022 Fall Enrollment 1st Admission opportunity			
2022 Fall Enrollment 2nd Admission opportunity			
2023 Spring Enrollment	9	53	13
2023 Fall Enrollment 1st Admission opportunity			
2023 Fall Enrollment 2nd Admission opportunity			



Top Global University Project in Japan

September 2014

Government has chosen **37 universities** to be role models for internationalization of Japanese higher education.

SIT receives federal funding as the **ONLY** private science and engineering university in Japan.





ADMISSIONS



SHIBAURA INSTITUTE OF TECHNOLOGY

Established 1927

SIT New Course of Study

IGP : Innovative Global Program at College of Engineering

English based degree program

Honors program attached to laboratory

Interdisciplinary Learning Approach

You could spend at TOYOSU Campus for entire college life.



IGP Outline

Name : **Innovative *G*lobal *P*rogram (IGP)**

Starting date: **October 2020**

Degree : **Bachelor of Engineering**

Affiliation : **College of Engineering**

No.of students: **Up to 9**
(it may increase in later years)

Campus : **Toyosu**



IGP Curriculum

Curriculum in conventional science and engineering fields

1st year 2nd year 3rd year 4th year

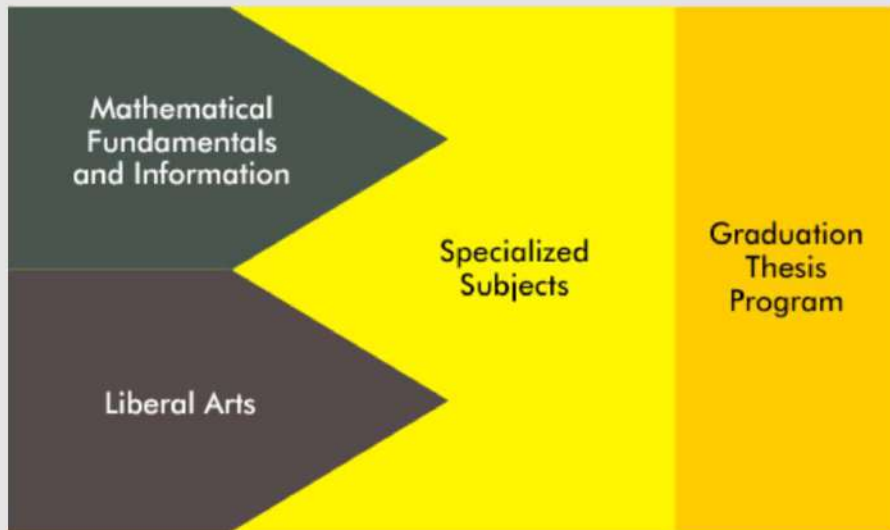

IGP Curriculum

1st year 2nd year 3rd year 4th year

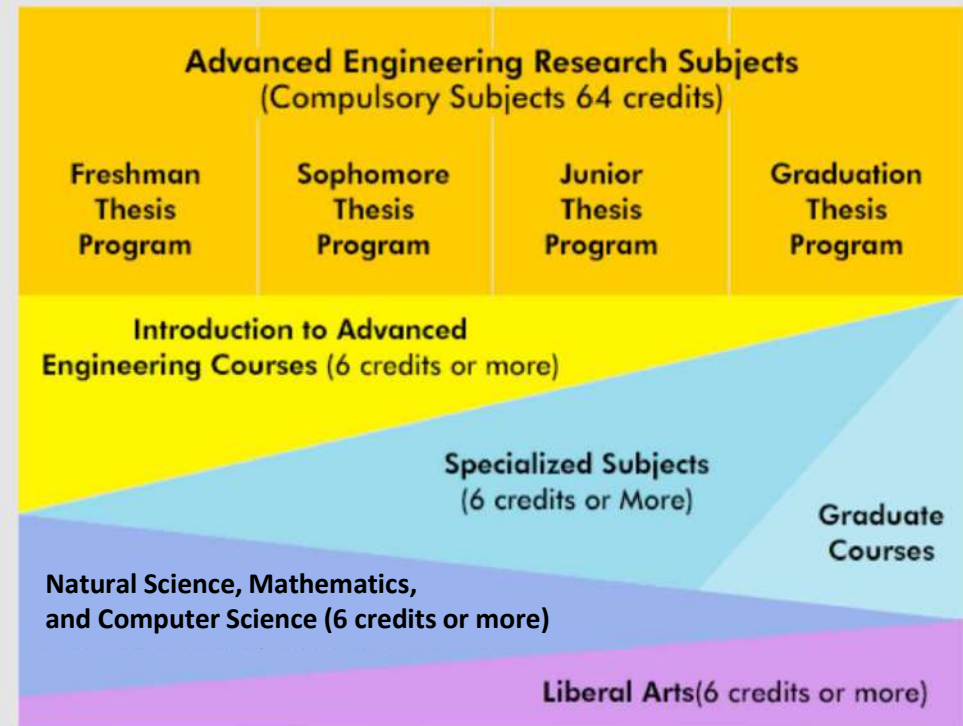

SHIBAURA INSTITUTE OF TECHNOLOGY

Established 1927

Application

**2025Fall Enrollment
Application Schedule
1st Application Opportunity**

【Application Period】

November 12 – December 3, 2024



Screening of Submitted Application Documents



**1st Screening Result Notification by
January 15, 2025**



**Online Interview & Oral Examination
for Successful Candidates**



Final Result Notification by March 24, 2025



SHIBAURA INSTITUTE OF TECHNOLOGY

Established 1927

Application

**2025Fall Enrollment
Application Schedule
2nd Application Opportunity**

**【Application Period】
February 28 – March 14, 2025**



Screening of Submitted Application Documents



**1st Screening Result Notification by
April 4, 2025**



**Online Interview & Oral Examination
for Successful Candidates**



Final Result Notification by May 23, 2025



Please access to IGP website!



SHIBAURA INSTITUTE OF TECHNOLOGY
Established 1927

Requirements for graduation

- 1. Complete a graduation thesis.*
- 2. Obtain at least **124 credits**.*
- 3. **64 credits** are devoted to **mandatory** research work in an **honor's program** (details later).*
- 4. All the courses offered are **electives** (except **Engineering Ethics**).*
- 5. Among the elective courses, students need to take at least **6 credits** of course work in **each category** (details later).*



Honor's program

Basic idea:

From the 1st-year, students have opportunities for learning & engaging themselves on cutting-edge research & activities.

1. Implementation:

- a) At the beginning of the 1st-year, each student is assigned one **supervisor** & **two advisors**.***
- b) Each student will belong to the laboratory of their supervisor, and learn & work on the topic of their interest.***

Note: Students can change their supervisors a few times until the beginning of the 3rd year.



Other categories of subjects:

- 1. Introduction to advanced engineering courses***
Introducing the cutting-edge research of faculty related to IGP
 - 2. Specialized subjects***
 - 3. Basic subjects on math, physics, chemistry, and computer science***
 - 4. Subjects in liberal arts, Sports, Japanese languages, and **Engineering Ethics*****
- Note: Students need to take at least **6 credits** from **each category**.***



IGP Admission Qualifications

- 1. Ability to think & communicate with others in English.***
- 2. Have a basic knowledge & understanding of such as mathematics and physics.***
- 3. Ability to cooperate with people from various backgrounds and cultures.***
- 4. Be enthusiastic about new things & challenges.***
- 5. Have strong interest in learning in IGP.***



Application eligibility

- Completion of the Japanese education system, either in Japan or overseas, or another 12-year curriculum (international school in Japan, overseas high school, etc.)***
- Possession of overseas university entry qualifications such as the International Baccalaureate, Abitur, Baccalaureate, or GCE-A level***
- Completion of a 12-year curriculum at an educational institution accredited by an international assessment organization (WASC, CIS, ACSI)***



Tuition Fee and scholarship

Tuition fee for 2024 academic year

	1 st year		2 nd year		3 rd year		4 th year	
	1・2 Quarter	3・4 Q	1・2 Q	3・4 Q	1・2 Q	3・4 Q	1・2 Q	3・4 Q
Enrollment fee	\280,000	-	-	-	-	-	-	-
Tuition	\599,500	\599,500	\599,500	\599,500	\649,500	\649,500	\649,500	\649,500
Maintenance fee	\141,500	\141,500	\141,500	\141,500	\141,500	\141,500	\141,500	\141,500
Supporters' organization enrollment fee	\10,000	-	-	-	-	-	-	-
Supporters' organization enrollment fee	\15,000	\15,000	-	\15,000	-	\15,000	-	-
Total	\1,021,000	\741,000	\741,000	\741,000	\791,000	\791,000	\791,000	\791,000

・Japanese Government (Ministry of Education, Culture, Sports, Science: hereafter referred to as “MEXT”) Scholarships.

The IGP is designated by the Japanese government as a scholarship-eligible program. For outstanding applicants, the university will waive tuition fees and the MEXT will provide a scholarship for up to 4 years. Applicants do not need to apply individually for this scholarship. SIT will notify outstanding applicants who have the eligible scores.



Tuition Fee and scholarship

Tuition fee for 2024 academic year

	1 st year		2 nd year		3 rd year		4 th year	
	1・2 Quarter	3・4 Q	1・2 Q	3・4 Q	1・2 Q	3・4 Q	1・2 Q	3・4 Q
Enrollment fee	\280,000	-	-	-	-	-	-	-
Tuition	\599,500	\599,500	\599,500	\599,500	\649,500	\649,500	\649,500	\649,500
Maintenance fee	\141,500	\141,500	\141,500	\141,500	\141,500	\141,500	\141,500	\141,500
Supporters' organization enrollment fee	\10,000	-	-	-	-	-	-	-
Supporters' organization enrollment fee	\15,000	\15,000	-	\15,000	-	\15,000	-	-
Total	\1,021,000	\741,000	\741,000	\741,000	\791,000	\791,000	\791,000	\791,000



Scholarship

·Japanese Government (Ministry of Education, Culture, Sports, Science: hereafter referred to as “MEXT”) Scholarships.

The IGP is designated by the Japanese government as a scholarship program. For outstanding applicants, the university will waive tuition fees and the MEXT will provide a scholarship for up to 4 years. Applicants do not need to apply individually for this scholarship. SIT will notify applicants who meet the eligibility requirements.

·Japan Student Services Organization (JASSO) Scholarships.

The IGP is designated by JASSO as a scholarship program. For outstanding and financially needy applicants, the JASSO will provide a scholarship for up to 6 months. Applicants do not need to apply individually for this scholarship. SIT will notify applicants who meet the eligibility requirements.



Scholarship

	Scholarship per month	Tuition fee	Travel expenses to and from Japan	Benefit period	terms and conditions
Japanese Government (“MEXT”) Scholarships.	117,000 yen	Provided according to MEXT guideline	Provided according to MEXT guideline	Up to 4 years	Conditionally Ex) Visa Status etc.
Japan Student Services Organization (JASSO) Scholarships	48,000 yen			Up to 6 months	Conditionally Ex) amount of monthly allowance etc.

